

# PITUMEC

## THE PCON 460 CONCENTRIC UNDERREAMING SYSTEM

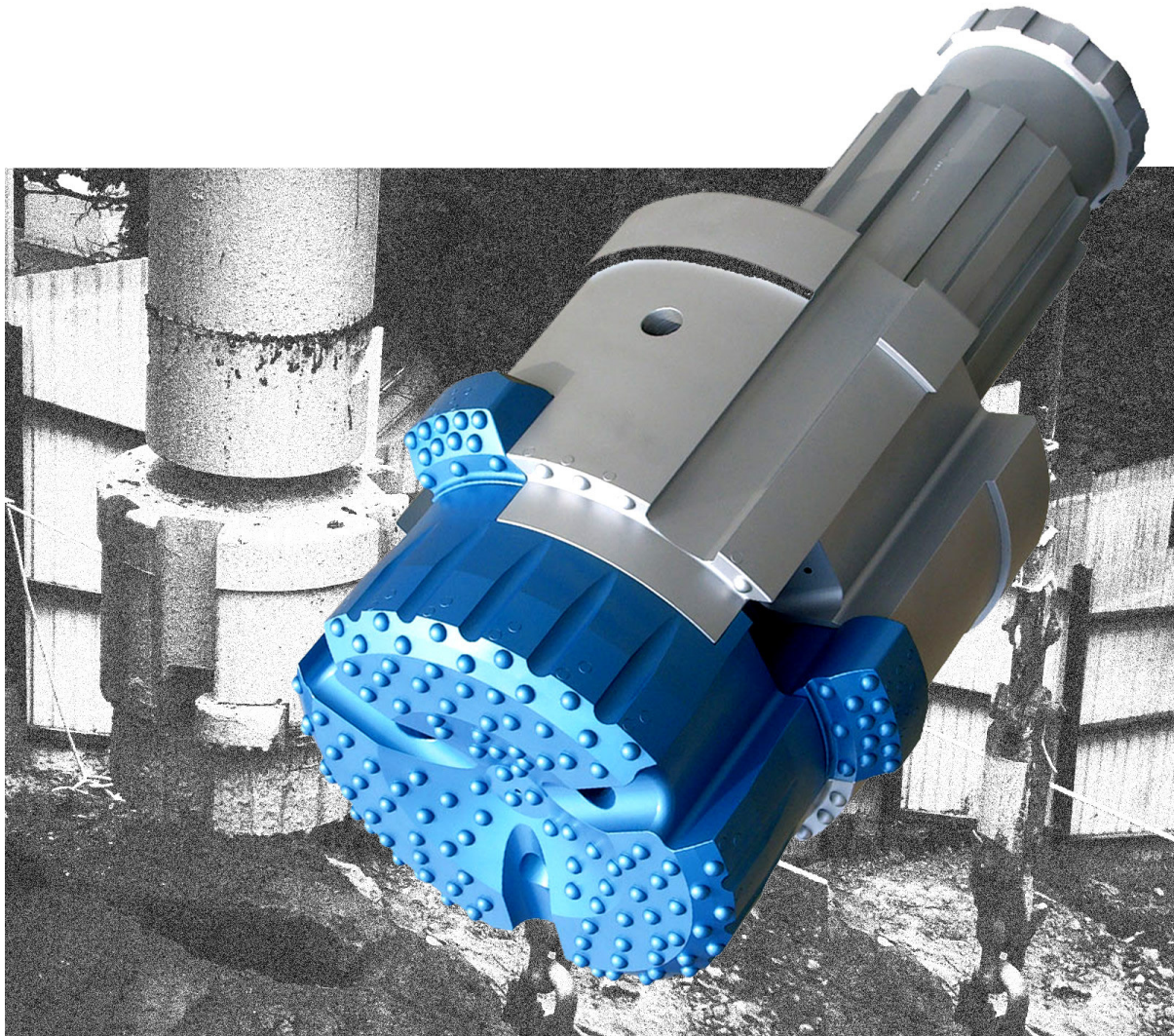

**CASING SIZE 508MM OD X 483MM ID DRILLING DIA. 530MM**

# PNEUMEC PCON 460 CONCENTRIC UNDERREAMING SYSTEM

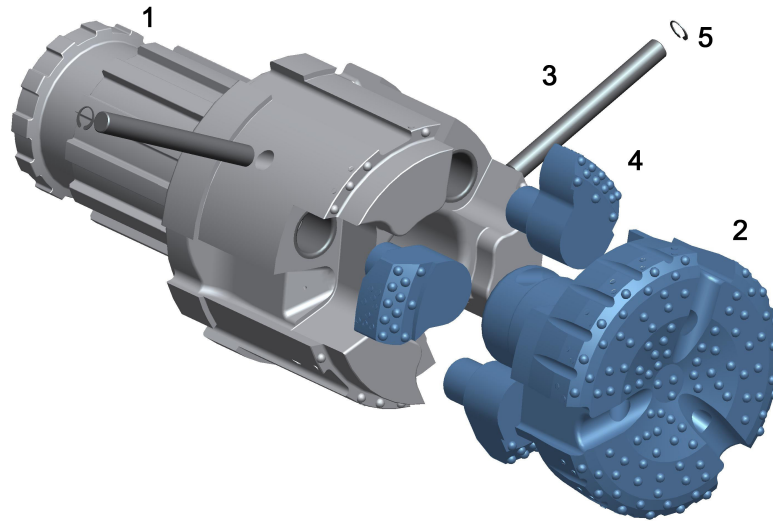

## PCON 460 PARTS LIST

1.	GUIDE DEVICE N125 SHANK	UGD460125PCN
2.	PILOT BIT	UPB460PCN
3.	LOCKING PIN (2)	USP46050PCN
4.	REAMER (3)	UBS460PCN
5.	CIRCLIP (2)	USP46053PCN
6.	COMPLETE SYSTEM N125 SHANK	UCS460125PCN

## PCON 460 SPECIFICATIONS

UPPER BODY DIAMETER	475MM	CLOSED DIAMETER	460MM
REAMING DIAMETER	530MM	CASING SIZE	508MM OD X 483MM ID
SYSTEM LENGTH	1100MM	SYSTEM WEIGHT	850KG

## PCON 460 CASING SHOES

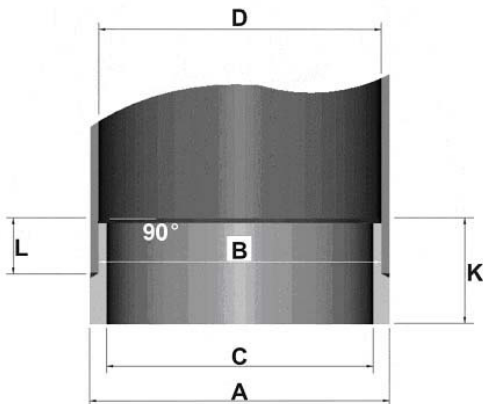

DIA. A	508MM
DIA. B	482.5MM
DIA. C	461.5MM
DIA. D	483MM
L	95MM
K	140MM

# PNEUMEC

**PNEUMEC COMPANY LIMITED**

1st Floor, Tin On Sing Comm. Bldg., 41-43 Graham St. Central, H.K.

Tel : (852) 2180 9922

Fax : (852) 2180 9982

Website : [www.pneumec.com](http://www.pneumec.com)

email : [info@pneumec.com](mailto:info@pneumec.com)